

SUNCOR STAINLESS, INC.

SHACKLES

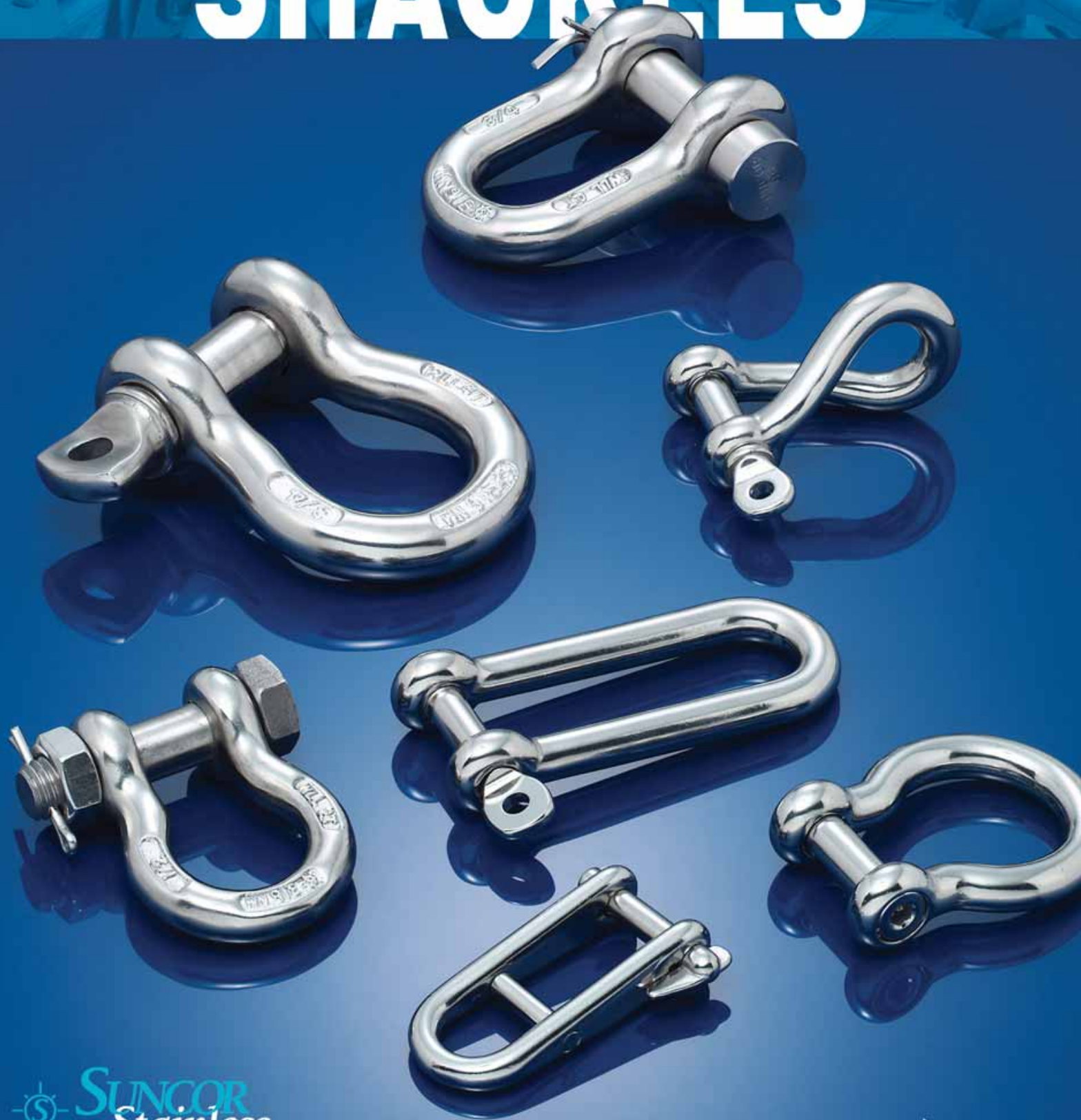

www.suncorstainless.com

STRAIGHT D SHACKLE

316 STAINLESS STEEL
WITH SCREW PIN

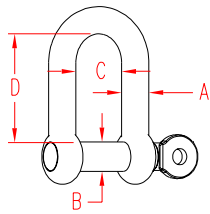

ITEM	A	B	C	D	WLL	WT
	(size)				(lb)	(lb)
S0115-0004	5/32"	0.15"	0.31"	0.55"	350	0.02
S0115-0005	3/16"	0.19"	0.45"	0.76"	530	0.04
S0115-0006	1/4"	0.23"	0.48"	0.85"	750	0.06
S0115-0008	5/16"	0.31"	0.67"	1.11"	1,300	0.14
S0115-0010	3/8"	0.39"	0.78"	1.37"	1,700	0.25
S0115-0012	15/32"	0.46"	0.95"	1.66"	2,200	0.43
S0115-0013	1/2"	0.54"	1.09"	1.84"	3,000	0.66
S0115-0016	5/8"	0.61"	1.25"	2.01"	4,400	0.90
S0115-0020	3/4"	0.74"	1.46"	2.57"	6,100	1.62
S0115-0022	7/8"	0.86"	1.72"	3.02"	8,000	2.49
S0115-0025	1"	0.96"	1.95"	3.45"	10,000	3.63
S0115-0032	1-1/4"	1.25"	2.50"	4.35"	12,000	7.42

STRAIGHT D SHACKLE

316 STAINLESS STEEL
WITH CAPTIVE PIN

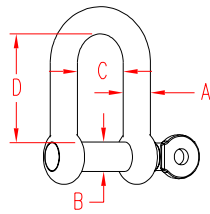

ITEM	A	B	C	D	WLL	WT
	(size)				(lb)	(lb)
S0115-CP04	5/32"	0.17"	0.32"	0.55"	350	0.02
S0115-CP05	3/16"	0.19"	0.37"	0.69"	530	0.03
S0115-CP06	1/4"	0.23"	0.47"	0.82"	750	0.05
S0115-CP08	5/16"	0.31"	0.62"	1.10"	1,300	0.12
S0115-CP10	3/8"	0.39"	0.79"	1.34"	1,700	0.23
S0115-CP12	1/2"	0.47"	0.95"	1.65"	2,200	0.38

NOTE:
SCREW PIN IS CAPTIVE AND NOT REMOVABLE. WHEN IT'S FULLY OPENED, THE END OF THE PIN WILL SIT FLUSH WITH THE INSIDE OF THE SHACKLE.

STRAIGHT D SHACKLE

316 STAINLESS STEEL
WITH "NO SNAG" PIN

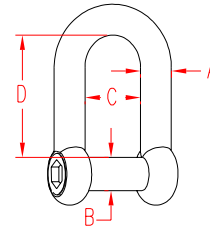

ITEM	A	B	C	D	WLL	WT
	(size)				(lb)	(lb)
S0115-NS06	1/4"	0.23"	0.48"	0.85"	750	0.05
S0115-NS08	5/16"	0.31"	0.67"	1.11"	1,300	0.13
S0115-NS10	3/8"	0.39"	0.79"	1.38"	1,700	0.24
S0115-NS12	15/32"	0.47"	0.93"	1.64"	2,200	0.41
S0115-NS13	1/2"	0.54"	1.09"	1.84"	3,000	0.64
S0115-NS16	5/8"	0.64"	1.27"	2.19"	4,400	0.94
S0115-NS20	3/4"	0.75"	1.50"	2.60"	6,100	1.55
S0115-NS22	7/8"	0.87"	1.73"	3.01"	8,000	2.44
S0115-NS25	1"	0.98"	1.94"	3.42"	10,000	3.56

NOTE:
NO SNAG PIN SITS FLUSH WITH BODY OF SHACKLE. LARGER SIZES WITH SLOTTED HEAD. SUNCOR RECOMMENDS THE USE OF A LOCKING FLUID WITH THIS TYPE OF SHACKLE.

WIDE D SHACKLE

316 STAINLESS STEEL
WITH SCREW PIN

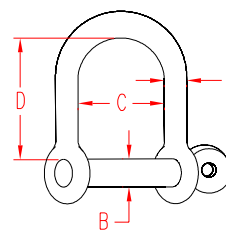

ITEM	A	B	C	D	WLL	WT
	(size)				(lb)	(lb)
S0114-0006	1/4"	0.24"	0.92"	1.31"	750	0.08
S0114-0008	5/16"	0.32"	1.11"	1.22"	1,300	0.14
S0114-0010	3/8"	0.40"	1.54"	2.14"	1,500	0.33
S0114-0012	1/2"	0.47"	1.89"	2.59"	2,200	0.56

STAMPED D SHACKLE

304 STAINLESS STEEL
WITH SCREW PIN

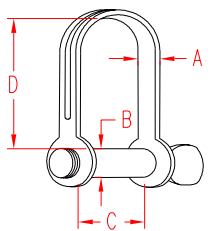

ITEM	A	B	C	D	WLL	WT
	(size)				(lb)	(lb)
S0118-0004	5/32"	0.16"	0.40"	0.59"	200	0.01
S0118-0005	3/16"	0.20"	0.40"	0.76"	250	0.02
S0118-0006	1/4"	0.24"	0.54"	0.95"	300	0.03
S0118-0008	5/16"	0.32"	0.71"	1.53"	450	0.07



Key:



Made in USA



Drop Forged



Precision Machined



Wire Formed



Suncor Exclusive



Import



Precision Cast



Stamped



Load Rated



New Product

ORDERS ONLY: 800-394-2222 (USA)
877-495-5510 (CANADA)

All logos, icons, images, measurements and descriptions are the sole property of Suncor Stainless, Inc.
© 2002 Suncor Stainless, Inc.

CHAIN SHACKLE

316-NM STAINLESS STEEL WITH OVERSIZE SCREW PIN

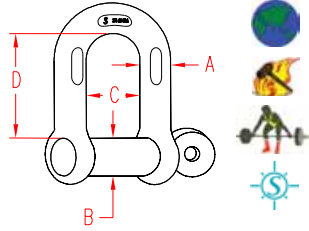

ITEM	A	B	C	D	WLL	WT
	(size)				(lb)	(lb)
S0115-FS07	1/4"	0.31"	0.46"	0.87"	1,000	0.09
S0115-FS08	5/16"	0.38"	0.52"	1.02"	1,500	0.16
S0115-FS10	3/8"	0.44"	0.65"	1.24"	2,000	0.28
S0115-FS12	7/16"	0.50"	0.75"	1.43"	3,000	0.43
S0115-FS13	1/2"	0.63"	0.79"	1.58"	4,000	0.70
S0115-FS16	5/8"	0.75"	1.05"	1.94"	6,000	1.70
S0115-FS20	3/4"	0.88"	1.20"	2.40"	8,000	2.13
S0115-FS22	7/8"	1.00"	1.45"	2.88"	10,000	3.22
S0115-FS25	1"	1.13"	1.67"	3.20"	12,000	4.77

NOTE:
1/A/W FED. SPECIFICATION RR-C-271D, TYPE IVB, CLASS 2, (EXCEPT 316 STAINLESS STEEL).

BOLT CHAIN SHACKLE

316-NM STAINLESS STEEL WITH OVERSIZE BOLT

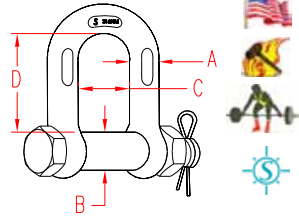

ITEM	A	B	C	D	WLL	WT
	(size)				(lb)	(lb)
S0115-SA07	1/4"	0.31"	0.46"	0.87"	1,000	0.11
S0115-SA08	5/16"	0.38"	0.52"	1.02"	1,500	0.18
S0115-SA10	3/8"	0.44"	0.65"	1.24"	2,000	0.31
S0115-SA12	7/16"	0.50"	0.75"	1.43"	3,000	0.50
S0115-SA13	1/2"	0.63"	0.79"	1.58"	4,000	0.74
S0115-SA16	5/8"	0.75"	1.05"	1.94"	6,000	1.41
S0115-SA20	3/4"	0.88"	1.20"	2.40"	8,000	2.36
S0115-SA22	7/8"	1.01"	1.45"	2.88"	10,000	3.46
S0115-SA25	1"	1.13"	1.67"	3.20"	12,000	4.85

NOTE:
1/A/W FED. SPECIFICATION RR-C-271D, TYPE IVB, CLASS 3, (EXCEPT 316 STAINLESS STEEL).

ROUND PIN CHAIN SHACKLE

316-NM STAINLESS STEEL WITH OVERSIZE ROUND PIN

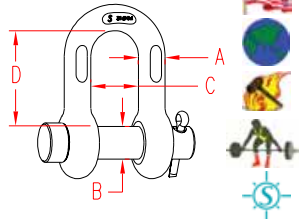

ITEM	A	B	C	D	WLL	WT
	(size)				(lb)	(lb)
S0115-RP07	1/4"	0.32"	0.46"	0.87"	1,000	0.09
S0115-RP08	5/16"	0.37"	0.52"	1.02"	1,500	0.16
S0115-RP10	3/8"	0.44"	0.65"	1.24"	2,000	0.28
S0115-RP12	7/16"	0.50"	0.75"	1.43"	3,000	0.43
S0115-RP13	1/2"	0.63"	0.79"	1.58"	4,000	0.70
S0115-RP16	5/8"	0.75"	1.05"	1.94"	6,000	1.70
S0115-RP20	3/4"	0.88"	1.20"	2.40"	8,000	2.13
S0115-RP22	7/8"	1.00"	1.45"	2.88"	10,000	3.22
S0115-RP25	1"	1.13"	1.67"	3.20"	12,000	4.77

NOTE:
1/A/W FED. SPECIFICATION RR-C-271D, TYPE IVB, CLASS 1, (EXCEPT 316 STAINLESS STEEL). OTHER SIZES AVAILABLE ON SPECIAL ORDER.

In Inches: Min. Size	Min. Pin Diameter	Maximum Unthreaded	Width between Eyes Nominal Tolerance (+)		Length inside Nominal Tolerance (+)		Major Diameter Threaded Eye Max.	Diameter Outside Eye Maximum	Weight per 100 shackles (app.)	WLL GRADE A
3/16	1/4	5/16	3/8	1/16	3/4	1/16	9/32	5/8	5	650
1/4	5/16	13/32	15/32	1/16	7/8	1/16	11/32	7/8	11	1,000
5/16	3/8	15/32	17/32	1/16	1-1/32	1/16	13/32	1	17	1,500
3/8	7/16	17/32	21/32	1/16	1-1/4	1/8	15/32	1-1/8	28	2,000
7/16	1/2	19/32	23/32	1/16	1-7/16	1/8	17/32	1-1/4	42	3,000
1/2	5/8	23/32	13/16	1/16	1-5/8	1/8	21/32	1-3/8	68	4,000
9/16	5/8	23/32	7/8	1/16	1-13/16	1/8	21/32	1-5/8	88	5,000
5/8	3/4	27/32	1-1/16	1/16	2	1/8	25/32	1-7/8	121	6,500
3/4	7/8	31/32	1-1/4	1/16	2-3/8	1/4	29/32	2-1/8	214	9,500
7/8	1	1-3/32	1-7/16	1/16	2-13/16	1/4	1-1/32	2-3/8	310	13,000
1	1-1/8	1-7/32	1-11/16	1/16	3-3/16	1/4	1-5/32	2-5/8	450	17,000

TWIST SHACKLE

316 STAINLESS STEEL WITH SCREW PIN

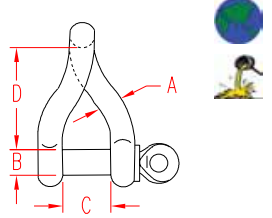

ITEM	A	B	C	D	WLL	WT
	(size)				(lb)	(lb)
S0163-0004	5/32"	0.16"	0.30"	0.63"	350	0.02
S0163-0005	3/16"	0.19"	0.38"	0.83"	530	0.04
S0163-0006	1/4"	0.23"	0.42"	1.00"	750	0.07
S0163-0008	5/16"	0.31"	0.55"	1.30"	1,300	0.16
S0163-0010	3/8"	0.38"	0.71"	1.80"	1,700	0.30
S0163-0012	1/2"	0.47"	0.78"	2.20"	2,200	0.51



TEL 508-732-9191 • FAX 508-732-9798 • ORDERS ONLY 800-394-2222

www.suncorstainless.com

LONG D SHACKLE

316 STAINLESS STEEL
WITH SCREW PIN

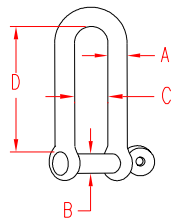

ITEM	A	B	C	D	WLL	WT
	(size)				(lb)	(lb)
S0138-0004	5/32"	0.15"	0.32"	1.19"	350	0.03
S0138-0005	3/16"	0.19"	0.43"	1.50"	530	0.05
S0138-0006	1/4"	0.23"	0.49"	1.74"	750	0.08
S0138-0008	5/16"	0.31"	0.68"	2.31"	1,320	0.18
S0138-0010	3/8"	0.38"	0.78"	2.88"	1,700	0.35
S0138-0012	1/2"	0.47"	0.93"	3.50"	2,200	0.62

LONG D SHACKLE

316 STAINLESS STEEL
WITH CAPTIVE PIN

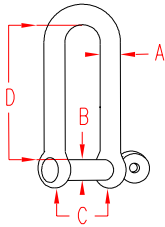

ITEM	A	B	C	D	WLL	WT
	(size)				(lb)	(lb)
S0138-CP04	5/32"	0.15"	0.30"	1.17"	350	0.03
S0138-CP05	3/16"	0.19"	0.39"	1.47"	530	0.05
S0138-CP06	1/4"	0.23"	0.46"	1.77"	750	0.08
S0138-CP08	5/16"	0.31"	0.61"	2.36"	1,300	0.18
S0138-CP10	3/8"	0.38"	0.78"	2.95"	1,700	0.34
S0138-CP12	1/2"	0.47"	0.93"	3.54"	2,200	0.57

NOTE:
SCREW PIN IS CAPTIVE AND NOT REMOVABLE. WHEN IT'S FULLY OPENED, THE END OF THE PIN WILL SIT FLUSH WITH THE INSIDE OF THE SHACKLE.

HALYARD SHACKLE

316 STAINLESS STEEL
WITH KEY PIN

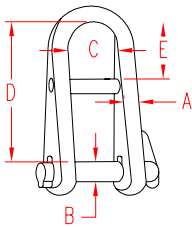

ITEM	A	B	C	D	E	WLL	WT
	(size)					(lb)	(lb)
S0164-0005	3/16"	0.20"	0.47"	1.48"	0.52"	450	0.07
S0164-0006	1/4"	0.24"	0.56"	1.70"	0.61"	600	0.11
S0164-0008	5/16"	0.31"	0.75"	2.37"	0.84"	1,300	0.25

LONG SHACKLE

316 STAINLESS STEEL
WITH KEY PIN

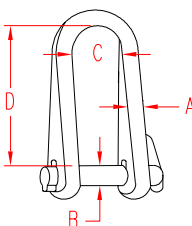

ITEM	A	B	C	D	WLL	WT
	(size)				(lb)	(lb)
S0167-0005	3/16"	0.20"	0.47"	1.43"	450	0.07
S0167-0006	1/4"	0.24"	0.56"	1.70"	600	0.11
S0167-0008	5/16"	0.31"	0.75"	2.30"	1,300	0.26

HEADBOARD SHACKLE

316 STAINLESS STEEL
WITH CAPTIVE PIN

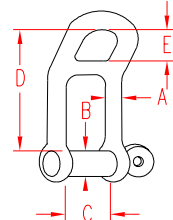

ITEM	A	B	C	D	E	WLL	WT
	(size)					(lb)	(lb)
S0173-0006	1/4"	0.30"	0.48"	1.70"	0.44"	750	0.10
S0173-0008	5/16"	0.38"	0.63"	2.20"	0.58"	1,300	0.22
S0173-0010	3/8"	0.47"	0.78"	2.80"	0.74"	1,700	0.42
S0173-0012	1/2"	0.54"	0.94"	3.25"	0.88"	2,500	0.71

NOTE:
SCREW PIN IS CAPTIVE AND NOT REMOVABLE. WHEN IT'S FULLY OPENED, THE END OF THE PIN WILL SIT FLUSH WITH THE INSIDE OF THE SHACKLE.



Key:



Made in USA



Drop Forged



Precision Machined



Wire Formed



Suncor Exclusive



Import



Precision Cast



Stamped



Load Rated



New Product

ORDERS ONLY: 800-394-2222 (USA)
877-495-5510 (CANADA)

All logos, icons, images, measurements and descriptions are the sole property of Suncor Stainless, Inc.
© 2002 Suncor Stainless, Inc.

ANCHOR SHACKLE

316-NM STAINLESS STEEL WITH OVERSIZE SCREW PIN

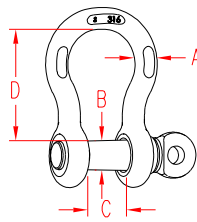

ITEM	A	B	C	D	WLL	WT
	(size)				(lb)	(lb)
S0116-FS05	3/16"	0.26"	0.41"	0.83"	650	0.05
S0116-FS07	1/4"	0.31"	0.47"	1.11"	1,000	0.10
S0116-FS08	5/16"	0.38"	0.53"	1.20"	1,500	0.17
S0116-FS10	3/8"	0.44"	0.66"	1.41"	2,000	0.30
S0116-FS12	7/16"	0.50"	0.72"	1.77"	3,000	0.50
S0116-FS13	1/2"	0.63"	0.82"	1.83"	4,000	0.71
S0116-FS16	5/8"	0.75"	1.02"	2.41"	6,000	1.39
S0116-FS20	3/4"	0.88"	1.25"	2.84"	8,000	2.31
S0116-FS22	7/8"	1.00"	1.48"	3.30"	10,000	3.64
S0116-FS25	1"	1.13"	1.70"	3.80"	12,000	5.18
S0116-FS32	1-1/4"	1.38"	2.03"	4.69"	17,000	9.88

NOTE: I/A/W FED SPEC RR-C-271D, TYPE IVA, CLASS 2, EXCEPT 316 STAINLESS.

NITRONIC ANCHOR SHACKLE

NITRONIC 50™ WITH OVERSIZE SCREW PIN

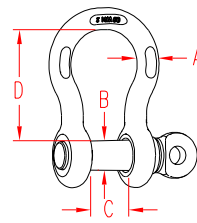

ITEM	A	B	C	D	WLL	WT
	(size)				(lb)	(lb)
S0116-NM07	1/4"	0.33"	0.49"	1.09"	1,500	0.12
S0116-NM10	3/8"	0.44"	0.66"	1.41"	3,000	0.30
S0116-NM13	1/2"	0.63"	0.82"	1.83"	6,000	0.71
S0116-NM16	5/8"	0.75"	1.02"	2.41"	9,000	1.39
S0116-NM20	3/4"	0.87"	1.25"	2.84"	12,000	2.31
S0116-NM22	7/8"	0.98"	1.54"	3.35"	14,000	3.62
S0116-NM25	1"	1.14"	1.72"	3.76"	16,000	5.17

NOTE: I/A/W MIL-F-17280D, TYPE 1. USED BY THE U.S. NAVY FOR MINESWEEPING. NITRONIC EYE & EYE SWIVEL, I/A/W MIL-F-17280D TYPE III, STYLE A, IS SHOWN IN RIGGING, PAGE 58.

BOLT ANCHOR SHACKLE

316-NM STAINLESS STEEL WITH OVERSIZE BOLT

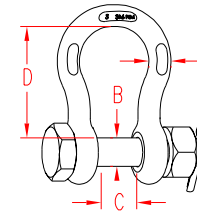

ITEM	A	B	C	D	WLL	WT
	(size)				(lb)	(lb)
S0116-SA07	1/4"	0.31"	0.47"	1.11"	1,000	0.12
S0116-SA08	5/16"	0.38"	0.53"	1.20"	1,500	0.18
S0116-SA10	3/8"	0.44"	0.66"	1.41"	2,000	0.35
S0116-SA12	7/16"	0.50"	0.72"	1.77"	3,000	0.57
S0116-SA13	1/2"	0.63"	0.82"	1.83"	4,000	0.84
S0116-SA16	5/8"	0.75"	1.02"	2.41"	6,000	1.64
S0116-SA20	3/4"	0.88"	1.25"	2.84"	8,000	2.75
S0116-SA22	7/8"	1.00"	1.48"	3.30"	10,000	4.18
S0116-SA25	1"	1.13"	1.70"	3.80"	12,000	5.61
S0116-SA32	1-1/4"	1.38"	2.03"	4.69"	17,000	9.88

NOTE: I/A/W FED SPEC RR-C-271D, TYPE IVA, CLASS 3, EXCEPT 316 STAINLESS. OTHER SIZES AVAILABLE ON SPECIAL ORDER.

ANCHOR SHACKLE

316-NM STAINLESS STEEL WITH OVERSIZE ROUND PIN

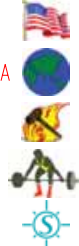
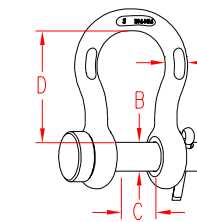

ITEM	A	B	C	D	WLL	WT
	(size)				(lb)	(lb)
S0116-RP07	1/4"	0.31"	0.47"	1.11"	1,000	0.10
S0116-RP08	5/16"	0.38"	0.53"	1.20"	1,500	0.17
S0116-RP10	3/8"	0.44"	0.66"	1.41"	2,000	0.32
S0116-RP12	7/16"	0.50"	0.72"	1.77"	3,000	0.49
S0116-RP13	1/2"	0.63"	0.82"	1.83"	4,000	0.72
S0116-RP16	5/8"	0.75"	1.02"	2.41"	6,000	1.53
S0116-RP20	3/4"	0.88"	1.25"	2.84"	8,000	2.36
S0116-RP22	7/8"	1.00"	1.48"	3.30"	10,000	4.00
S0116-RP25	1"	1.13"	1.70"	3.80"	12,000	5.27
S0116-RP32	1-1/4"	1.38"	2.03"	4.69"	17,000	9.88

NOTE: I/A/W FEDERAL SPECIFICATION RR-C-271D, TYPE IVA, CLASS 1, EXCEPT 316 STAINLESS.

FEDERAL SPECIFICATION RR-C-271D, TYPE IVA

In Inches: Min. Size	Min. Pin Diameter	Maximum Unthreaded	Width between Eyes Nominal Tolerance (+/-)		Length inside Nominal Tolerance (+/-)		Width Bow Minimum	Major Diameter Threaded Eye Max.	Diameter Outside Eye Maximum	Weight per 100 shackles (app.)	WLL GRADE A
3/16	1/4	5/16	3/8	1/16	7/8	1/16	9/16	9/32	5/8	5	650
1/4	5/16	13/32	15/32	1/16	1-1/8	1/16	3/4	11/32	7/8	12	1,000
5/16	3/8	15/32	17/32	1/16	1-1/4	1/16	13/16	13/32	1	18	1,500
3/8	7/16	17/32	21/32	1/16	1-7/16	1/8	15/16	15/32	1-1/8	30	2,000
7/16	1/2	19/32	23/32	1/16	1-11/16	1/8	1-1/16	17/32	1-1/4	49	3,000
1/2	5/8	23/32	13/16	1/16	1-7/8	1/8	1-3/16	21/32	1-3/8	74	4,000
9/16	5/8	23/32	7/8	1/16	2-1/8	1/8	1-5/8	21/32	1-5/8	92	5,000
5/8	3/4	27/32	1-1/16	1/16	2-13/32	1/8	1-1/2	25/32	1-7/8	144	6,500
3/4	7/8	31/32	1-1/4	1/16	3-27/32	1/4	1-3/4	29/32	2-1/8	216	9,500
7/8	1	1-3/32	1-7/16	1/16	3-5/16	1/4	2	1-1/32	2-3/8	337	13,000
1	1-1/8	1-7/32	1-11/16	1/16	3-3/4	1/4	2-5/16	1-5/32	2-5/8	530	17,000



TEL 508-732-9191 • FAX 508-732-9798 • ORDERS ONLY 800-394-2222
www.suncorstainless.com

BOW SHACKLE



**316 STAINLESS STEEL
WITH SCREW PIN**

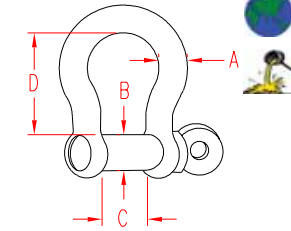

ITEM	A	B	C	D	WLL	WT
	(size)				(lb)	(lb)
S0116-0004	5/32"	0.16"	0.33"	0.75"	350	0.02
S0116-0005	3/16"	0.19"	0.43"	0.94"	530	0.04
S0116-0006	1/4"	0.23"	0.48"	1.08"	750	0.07
S0116-0008	5/16"	0.31"	0.67"	1.46"	1,300	0.16
S0116-0010	3/8"	0.39"	0.79"	1.77"	1,700	0.26
S0116-0012	15/32"	0.48"	0.94"	2.16"	2,200	0.50
S0116-0013	1/2"	0.51"	1.04"	2.33"	3,000	0.77
S0116-0016	5/8"	0.63"	1.25"	3.00"	4,000	1.21
S0116-0020	3/4"	0.74"	1.50"	3.34"	5,600	1.80
S0116-0022	7/8"	0.86"	1.72"	3.85"	6,700	2.90
S0116-0025	1"	0.96"	1.95"	4.42"	9,000	4.34
S0116-0032	1-1/4"	1.24"	2.50"	5.44"	10,000	9.02

BOW SHACKLE



**316 STAINLESS STEEL
WITH NO SNAG PIN**

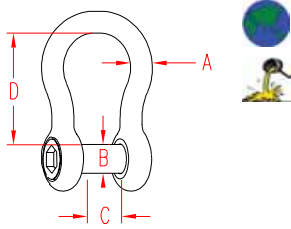

ITEM	A	B	C	D	WLL	WT
	(size)				(lb)	(lb)
S0116-NS06	1/4"	0.24"	0.47"	1.06"	750	0.06
S0116-NS08	5/16"	0.31"	0.67"	1.46"	1,300	0.16
S0116-NS10	3/8"	0.39"	0.79"	1.77"	1,700	0.26
S0116-NS12	15/32"	0.48"	0.94"	2.16"	2,200	0.46
S0116-NS13	1/2"	0.51"	1.04"	2.33"	3,000	0.70
S0116-NS16	5/8"	0.63"	1.25"	3.00"	4,000	1.13
S0116-NS20	3/4"	0.74"	1.50"	3.34"	5,600	1.75
S0116-NS22	7/8"	0.86"	1.72"	3.85"	6,700	2.85
S0116-NS25	1"	0.96"	1.95"	4.42"	9,000	4.30

NOTE:
NO SNAG PIN SITS FLUSH WITH BODY OF SHACKLE. LARGER SIZES WITH SLOTTED HEAD. SUNCOR RECOMMENDS THE USE OF A LOCKING FLUID WITH THIS TYPE OF SHACKLE.

WEBBING SHACKLE



316 STAINLESS STEEL

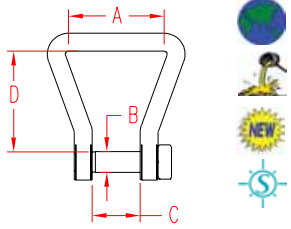

ITEM	A	B	C	D	WLL	WT
	(size)				(lb)	(lb)
S0231-0025	1"	0.19"	0.33"	1.14"	200	0.03

NOTE:
PATENTED "NO SNAG" DESIGN. CAN BE USED IN COMBINATION WITH WALL CLIP S0230-0000 ON PAGE 83; PIN FITS THROUGH HOLE IN CLIP. USE WITH FLAT WEB HOOK (SHOWN) OR WEBBING WITH SEWN LOOP (S0232-SERIES) ON PAGE 80. COMPATIBLE WITH SWIVEL PAD EYE.



316-NM™ or NM-50™

A SUNCOR exclusive, 316-NM™ is permanently embossed during the hot forging process into selected U.S. Federal Specification shackles, turnbuckles, eye nuts, eye bolts, swivels, master links, and wire rope clips. We use 316-NM™ to signify Type 316 superior stainless™, less than 1.1 mu (magnetic units) and in compliance with applicable Federal Specifications.

We use NM-50™ to signify Nitronic 50™ non-magnetic products that are made to stringent military specifications and used primarily by the U.S. Navy.



T0531 series Titanium, call



T0533 series Titanium, call



S0650 series, page 66



S0655 series, page 59



Key:



Made in USA



Drop Forged



Precision Machined



Wire Formed



Suncor Exclusive



Import



Precision Cast



Stamped



Load Rated



New Product

ORDERS ONLY: 800-394-2222 (USA)
877-495-5510 (CANADA)

All logos, icons, images, measurements and descriptions are the sole property of Suncor Stainless, Inc.
© 2002 Suncor Stainless, Inc.